

Code	Mode	Drawing Title	Scale @A0	Revision
<b>VAL DI Fiemme Cluster</b>				
<b>TESERO CROSS-COUNTRY STADIUM - OLY Cross-Country, Nordic Combined / PAR Para Biathlon, Para Cross-Country</b>				
41_TCS_OLY_00_AL0	OLY	Aerial View	1:1500	3
41_TCS_OLY_00_AL1	OLY	Masterplan	1:1000	3
41_TCS_PAR_00_AL0	PAR	Aerial View	1:1500	3
41_TCS_PAR_00_AL1	PAR	Masterplan	1:1000	3
<b>Predazzo Ski Jumping Stadium - OLY Ski Jumping, Nordic Combined</b>				
42_Psj_OLY_00_AL0	OLY	Aerial View	1:1000	3
42_Psj_OLY_00_AL1	OLY	Masterplan	1:1000	3
<b>Predazzo Olympic &amp; Paralympic Village - OLY / PAR</b>				
43_Prv_NCO_00_AL0	OLY	Aerial View	1:500	3
43_Prv_NCO_00_AL1	OLY	Masterplan	1:500	3
43_Prv_NCP_00_AL0	PAR	Aerial View	1:500	3
43_Prv_NCP_00_AL1	PAR	Masterplan	1:500	3

© 2021 FONDAZIONE MILANO CORTINA 2026 - ALL RIGHTS RESERVED.  
THIS DRAWING IS THE PROPERTY OF THE ORGANISING COMMITTEE FOR THE  
2026 OLYMPIC AND PARALYMPIC WINTER GAMES AND IS STRICTLY CONFIDENTIAL.  
IT IS NOT TO BE DISTRIBUTED, REPRODUCED OR ALTERED IN ANY WAY AS WHOLE OR IN PARTS  
WITHOUT WRITTEN PERMISSION OF FONDAZIONE MILANO CORTINA 2026.  
FONDAZIONE MILANO CORTINA 2026 SHALL HAVE NO RESPONSIBILITY OR LIABILITY FOR THE  
SUITABILITY, ACCURACY, OR COMPLETENESS OF THE INFORMATION IT CONTAINS.  
ALL DIMENSIONS AND LEVELS MUST BE VERIFIED ON SITE AND ANY DISCREPANCIES ARE TO BE  
REPORTED TO FONDAZIONE MILANO CORTINA 2026 BEFORE PROCEEDING WITH ANY RELATED WORKS.

## TESERO CROSS-COUNTRY STADIUM Cross-Country, Nordic Combined

### LEGEND

AREA / FUNCTION	ROUTE / FLOW		
	Pedestrian	Vehicular	Entry Point
Field Of Play			
Athletes			
Olympic / Paralympic Family			
In Venue Hospitality   *Experience			
Spectators			
Broadcast			
Press			
Security			
Venue Operations			
Ceremonies			
Unavailable / Not to be used			
Multiple Client Groups			

	Parking Area		Venue Secure Perimeter
	Load Zone		Internal Division / Fence
	PSA Pedestrian Screening Area		Inner Perimeter
	VSA Vehicles Screening Area		Existing Division / Fence
	Metro Station		

### REVISIONS

No.	STATUS	DATE
1	Venue Design Book 1	15/11/2021
2	Venue Design Book 2	28/10/2022
3	Venue Design Book 3	15/12/2023

### NOTES

FOP		Classic 2.50 km		Free 2.50 km
		Classic 3.30 km (addition)		Free 3.30 km
		Classic 3.75 km		Free 3.75 km

### KEY PLAN

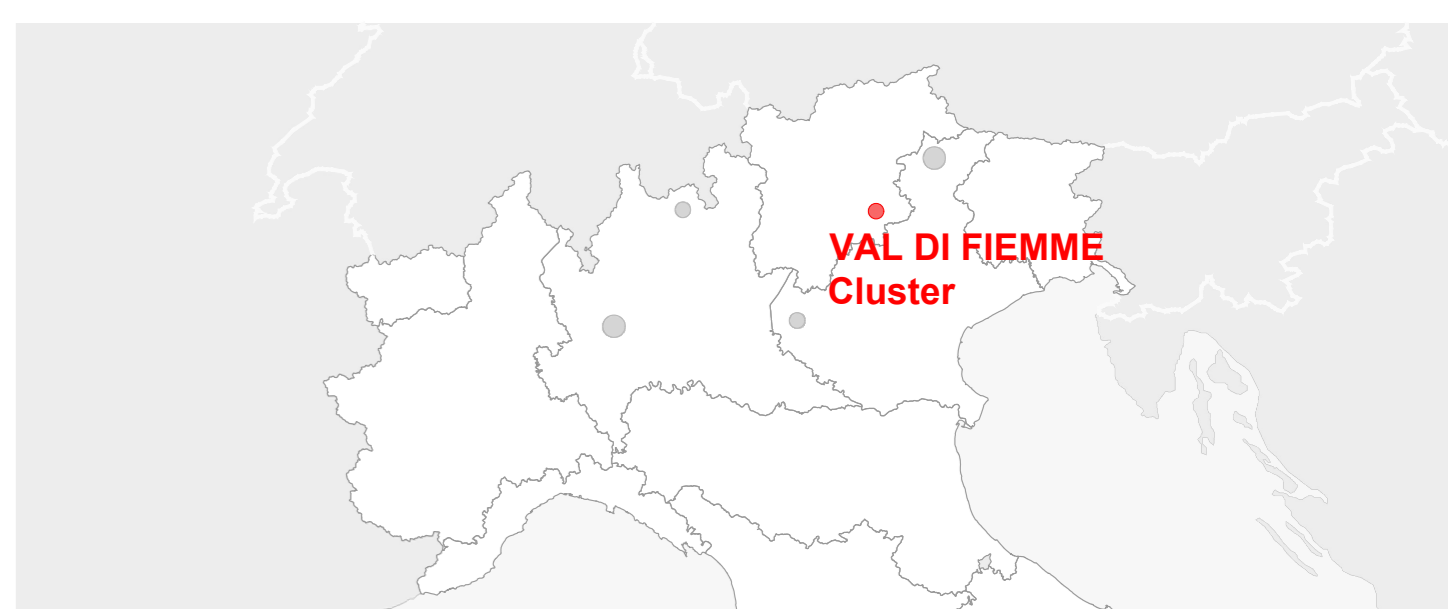

### DRAWING CODE

41\_TCS\_OLY\_00\_AL0

### DRAWING TITLE

Olympic Mode  
AERIAL VIEW

### DATE

15/12/2023

### STATUS

VENUE DESIGN BOOK 3

### REVISION No.

3

### SCALE @A0

1:1500

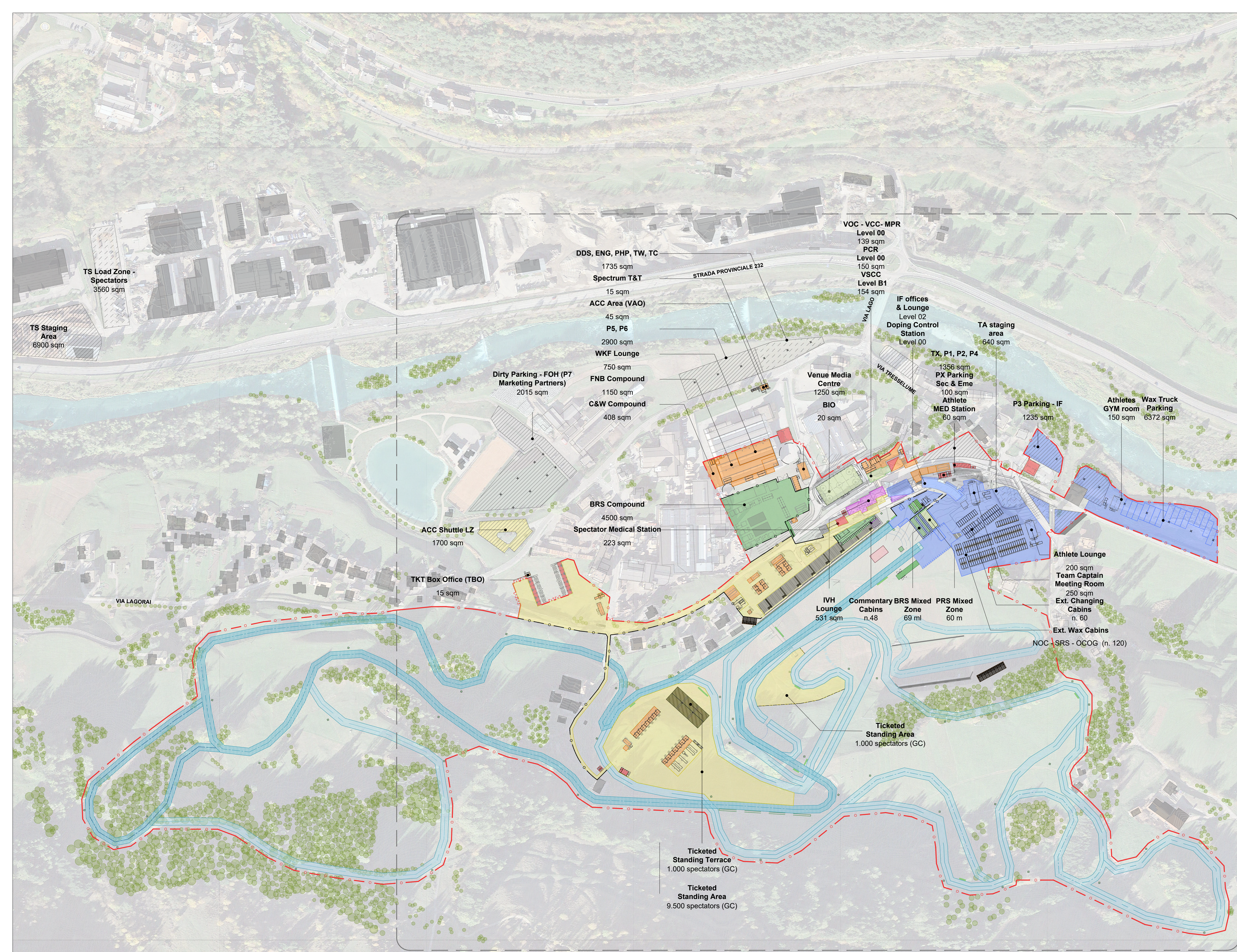
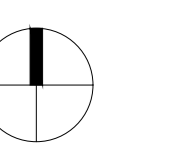
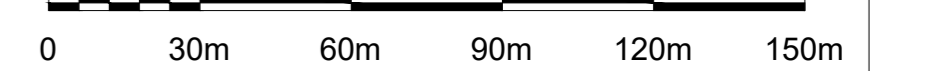

41\_TCS\_OLY\_00\_AL1

© 2021 FONDAZIONE MILANO CORTINA 2026 - ALL RIGHTS RESERVED.  
THIS DRAWING IS THE PROPERTY OF THE ORGANISING COMMITTEE FOR THE  
2026 OLYMPIC AND PARALYMPIC WINTER GAMES AND IS STRICTLY CONFIDENTIAL.  
IT IS NOT TO BE DISTRIBUTED, REPRODUCED OR ALTERED IN ANY WAY AS WHOLE OR IN PARTS  
WITHOUT WRITTEN PERMISSION OF FONDAZIONE MILANO CORTINA 2026.  
FONDAZIONE MILANO CORTINA 2026 SHALL HAVE NO RESPONSIBILITY OR LIABILITY FOR THE  
SUITABILITY, ACCURACY, OR COMPLETENESS OF THE INFORMATION IT CONTAINS.  
ALL DIMENSIONS AND LEVELS MUST BE VERIFIED ON SITE AND ANY DISCREPANCIES ARE TO BE  
REPORTED TO FONDAZIONE MILANO CORTINA 2026 BEFORE PROCEEDING WITH ANY RELATED WORKS.

## TESERO CROSS-COUNTRY STADIUM Cross-Country, Nordic Combined

### LEGEND

AREA / FUNCTION	ROUTE / FLOW		
	Pedestrian	Vehicular	Entry Point
Field Of Play			
Athletes	Blue dashed arrow	Blue solid arrow	Blue triangle
Olympic / Paralympic Family	Blue dashed arrow with 'x'	Blue solid arrow with 'x'	Blue triangle with 'x'
In Venue Hospitality   *Experience	Purple dashed arrow	Purple solid arrow	Purple triangle
Spectators	Yellow dashed arrow	Yellow solid arrow	Yellow triangle
Broadcast	Green dashed arrow	Green solid arrow	Green triangle
Press	Red dashed arrow	Red solid arrow	Red triangle
Security	Orange dashed arrow	Orange solid arrow	Orange triangle
Venue Operations	Light blue dashed arrow	Light blue solid arrow	Light blue triangle
Ceremonies	Pink dashed arrow	Pink solid arrow	Pink triangle
Unavailable / Not to be used	Grey dashed arrow	Grey solid arrow	Grey triangle
Multiple Client Groups	Multi-colored dashed arrow	Multi-colored solid arrow	Multi-colored triangle

	Parking Area		Venue Secure Perimeter
	Load Zone		Internal Division / Fence
	PSA Pedestrian Screening Area		Inner Perimeter
	VSA Vehicles Screening Area		Existing Division / Fence
	Metro Station		

### REVISIONS

No.	STATUS	DATE
1	Venue Design Book 1	15/11/2021
2	Venue Design Book 2	28/10/2022
3	Venue Design Book 3	15/12/2023

### NOTES

	FOP Classic 2.50 km		Free 2.50 km
	Classic 3.30 km (addition)		Free 3.30 km
	Classic 3.75 km		Free 3.75 km

### KEY PLAN

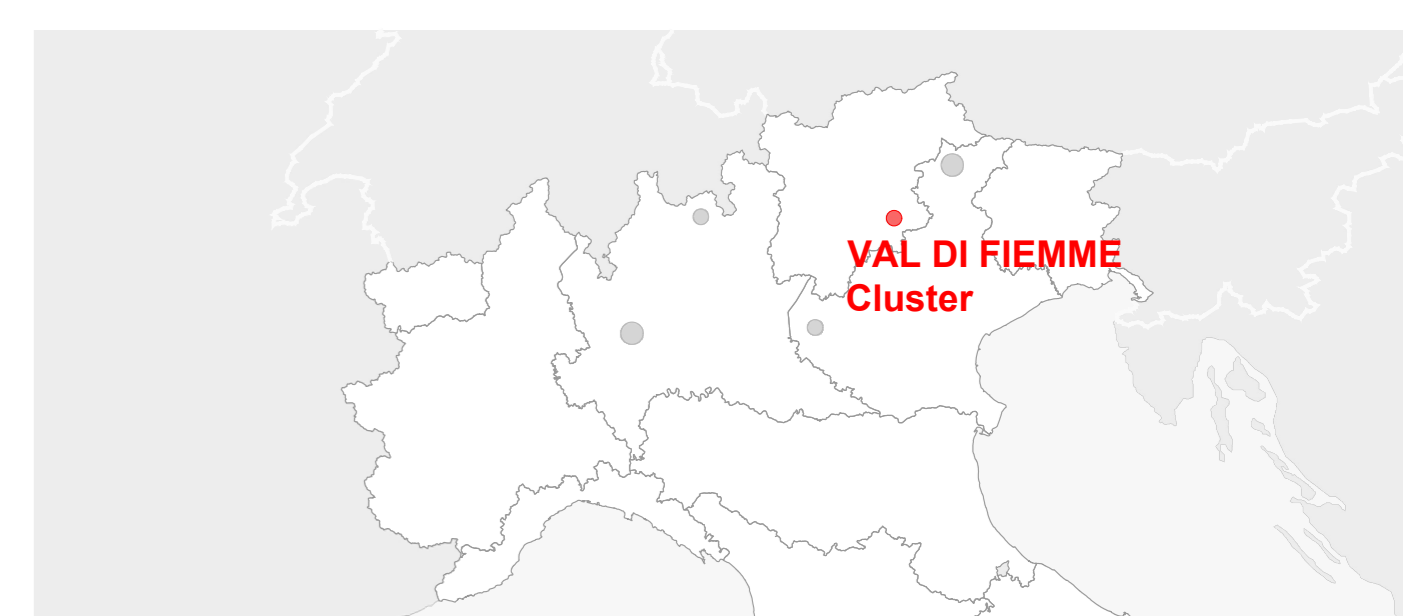

### DRAWING CODE

41\_TCS\_OLY\_00\_AL1

### DRAWING TITLE

Olympic Mode  
MASTERPLAN

### DATE

15/12/2023

### STATUS

VENUE DESIGN BOOK 3

### REVISION No.

3

### SCALE @A0

1:1000

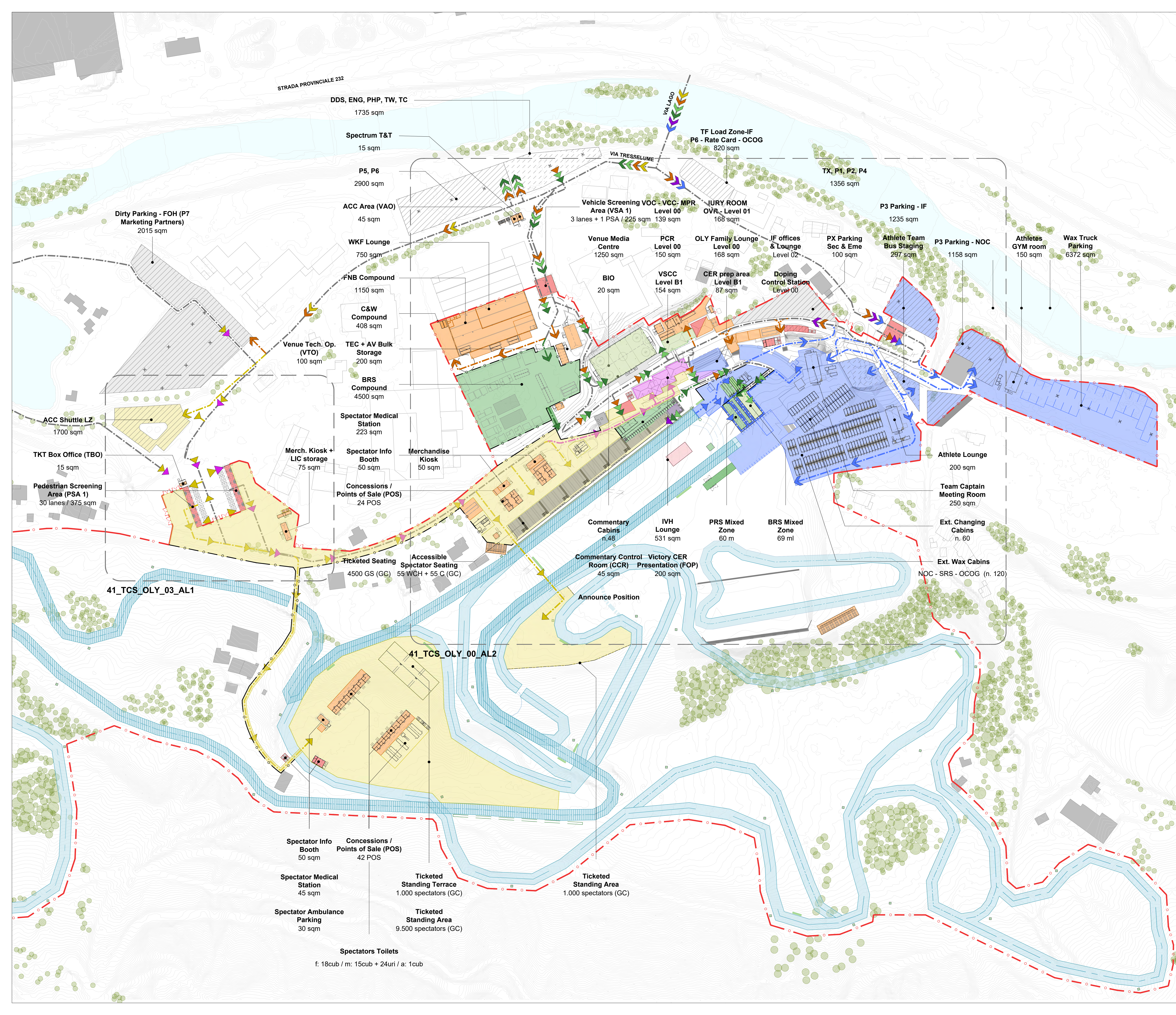
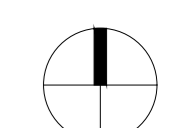
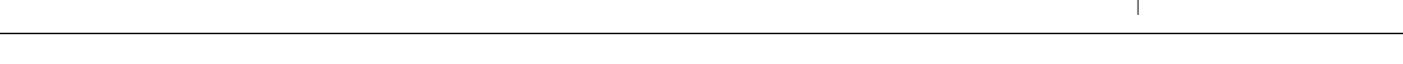

© 2021 FONDAZIONE MILANO CORTINA 2026 - ALL RIGHTS RESERVED.  
THIS DRAWING IS THE PROPERTY OF THE ORGANISING COMMITTEE FOR THE  
2026 OLYMPIC AND PARALYMPIC WINTER GAMES AND IS STRICTLY CONFIDENTIAL.  
IT IS NOT TO BE DISTRIBUTED, REPRODUCED OR ALTERED IN ANY WAY AS WHOLE OR IN PARTS  
WITHOUT WRITTEN PERMISSION OF FONDAZIONE MILANO CORTINA 2026.  
FONDAZIONE MILANO CORTINA 2026 SHALL HAVE NO RESPONSIBILITY OR LIABILITY FOR THE  
SUITABILITY, ACCURACY, OR COMPLETENESS OF THE INFORMATION IT CONTAINS.  
ALL DIMENSIONS AND LEVELS MUST BE VERIFIED ON SITE AND ANY DISCREPANCIES ARE TO BE  
REPORTED TO FONDAZIONE MILANO CORTINA 2026 BEFORE PROCEEDING WITH ANY RELATED WORKS.

## TESERO CROSS-COUNTRY STADIUM Para Biathlon, Para Cross-Country

### LEGEND

AREA / FUNCTION	ROUTE / FLOW		
	Pedestrian	Vehicular	Entry Point
Field Of Play			
Athletes			
Olympic / Paralympic Family			
In Venue Hospitality   *Experience			
Spectators			
Broadcast			
Press			
Security			
Venue Operations			
Ceremonies			
Unavailable / Not to be used			
Multiple Client Groups			

	Parking Area		Venue Secure Perimeter
	Load Zone		Internal Division / Fence
	PSA Pedestrian Screening Area		Inner Perimeter
	VSA Vehicles Screening Area		Existing Division / Fence
	Metro Station		

### REVISIONS

No.	STATUS	DATE
1	Venue Design Book 1	15/11/2021
2	Venue Design Book 2	28/10/2022
3	Venue Design Book 3	15/12/2023

### NOTES

FOP	
Paralympic FoP	

### KEY PLAN

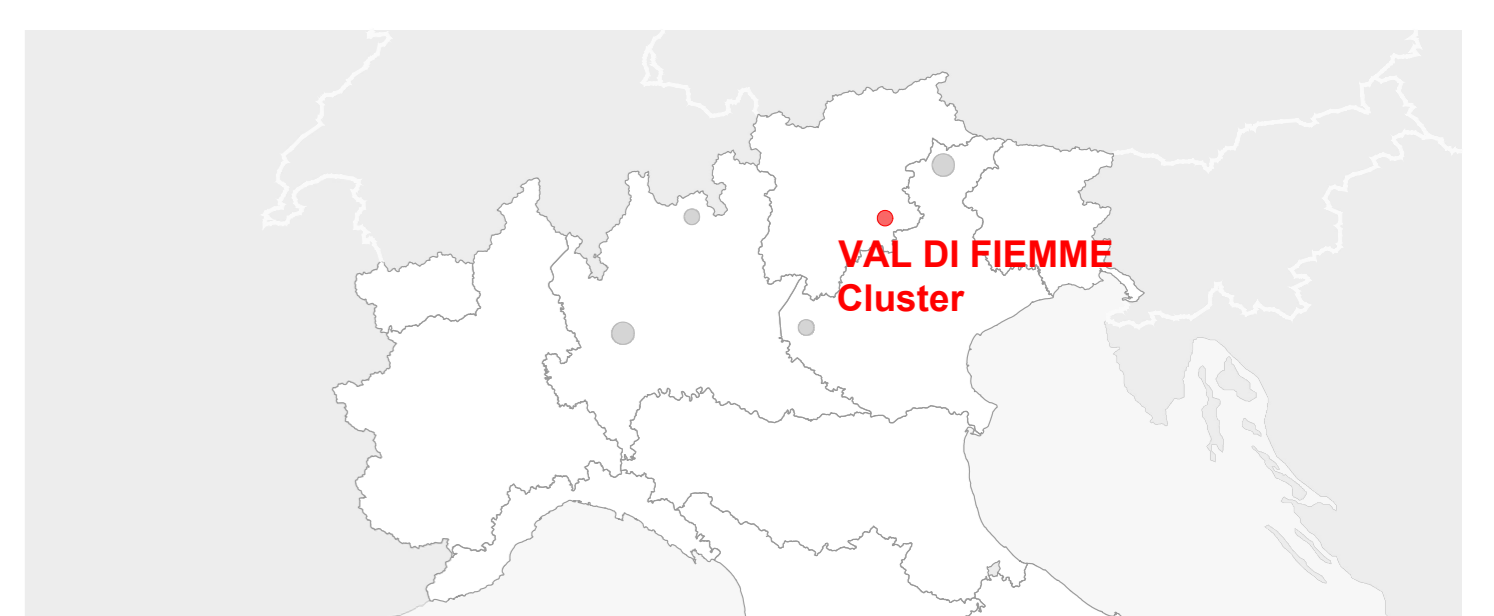

### DRAWING CODE

**41\_TCS\_PAR\_00\_AL0**

DRAWING TITLE	DATE
Paralympic Mode AERIAL VIEW	15/12/2023

STATUS	REVISION No.
VENUE DESIGN BOOK 3	3

SCALE @A0		
1:1500	0 30m 60m 90m 120m 150m	

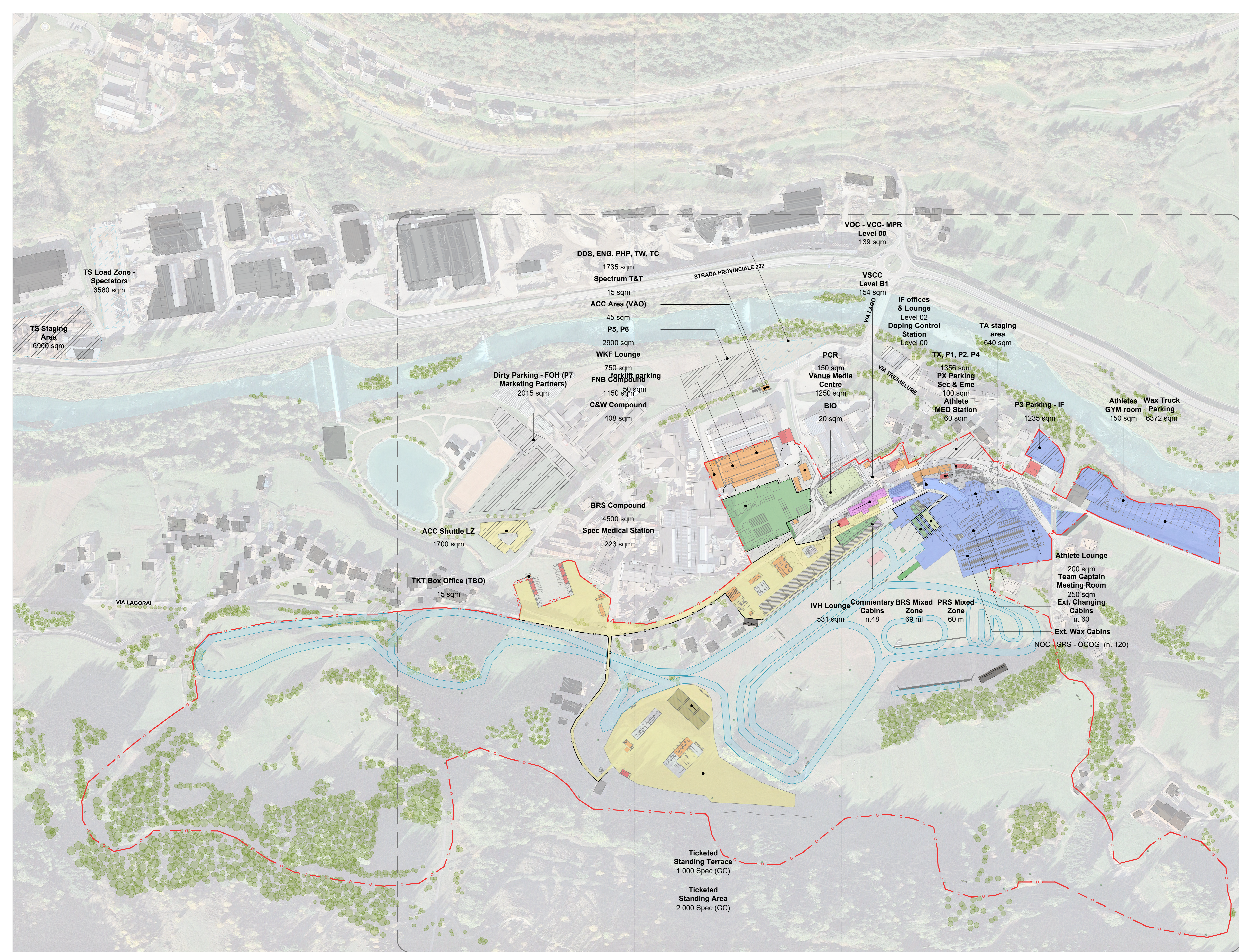

41\_TCS\_PAR\_00\_AL1



# PREDAZZO SKI JUMPING STADIUM Ski Jumping, Nordic Combined

## LEGEND

AREA / FUNCTION	ROUTE / FLOW		
	Pedestrian	Vehicular	Entry Point
Field Of Play	→	→	→
Athletes	→	→	→
Olympic / Paralympic Family	→	→	→
In Venue Hospitality   *Experience	→	→	→
Spectators	→	→	→
Broadcast	→	→	→
Press	→	→	→
Security	→	→	→
Venue Operations	→	→	→
Ceremonies	→	→	→
Unavailable / Not to be used	→	→	→
Multiple Client Groups	→	→	→

	Parking Area		Venue Secure Perimeter
	Load Zone		Internal Division / Fence
	PSA Pedestrian Screening Area		Inner Perimeter
	VSA Vehicles Screening Area		Existing Division / Fence
	Metro Station		

## REVISIONS

No.	STATUS	DATE
1	Venue Design Book 1	15/11/2021
2	Venue Design Book 2	28/10/2022
3	Venue Design Book 3	15/12/2023

## NOTES

## KEY PLAN

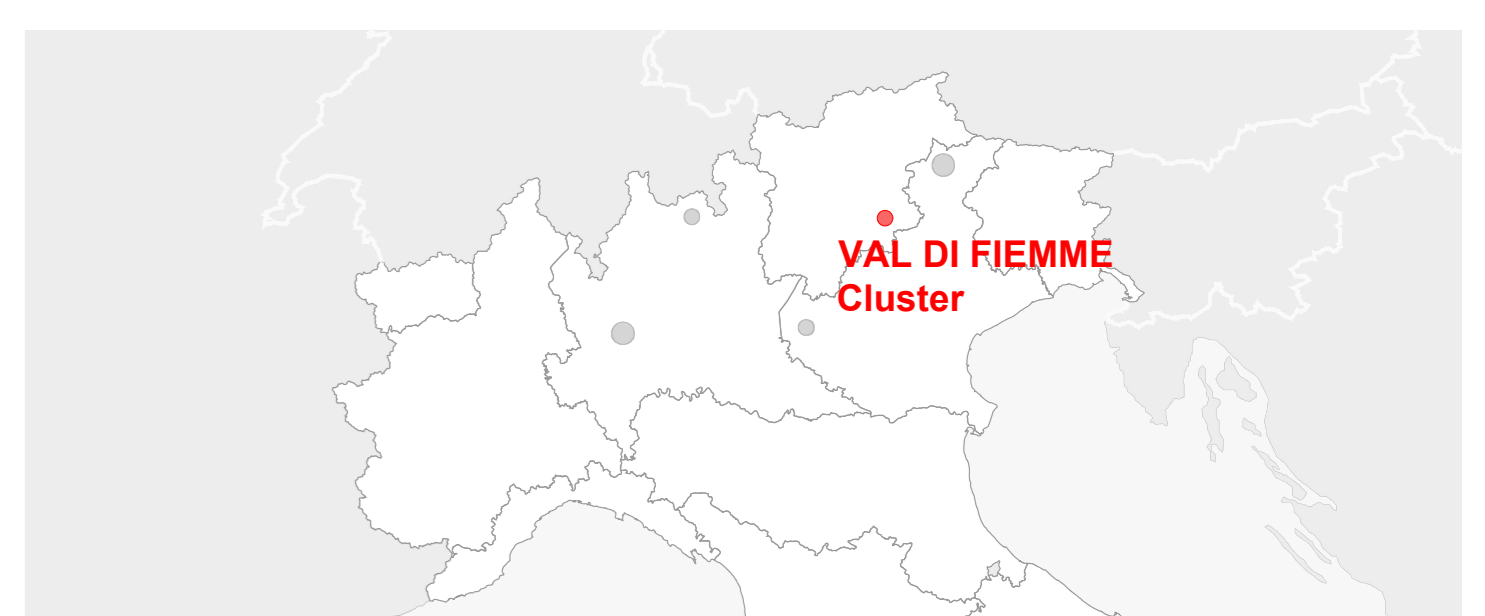

## DRAWING CODE

42\_P SJ\_OLY\_00\_AL0

DRAWING TITLE	DATE
Olympic Mode AERIAL VIEW	15/12/2023

STATUS	REVISION No.
VENUE DESIGN BOOK 3	3

## SCALE @A0

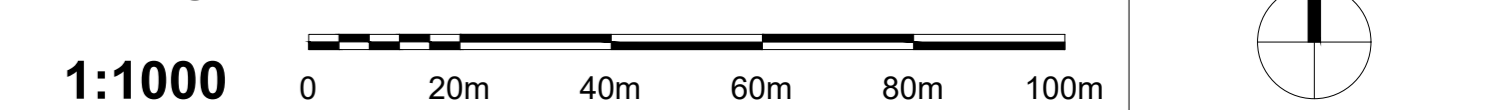

- BAITA ATLETI
- IF OFFICES
- 1 M+F+A Toilets 36 sqm
- 2 IF Offices 40 sqm
- 3 IF Work Area 45 sqm
- 4 IF Break Area 25 sqm
- 5 IF Storage 15 sqm
- 6 IF meeting room

- Vehicle Screening Area (VSA2)
- 2 lanes + 1PSA / 150 sqm

- TA Load Zone - Athletes and NOCF
- TF Load Zone-International Federations 250 sqm
- P3 Parking - IF 290 sqm

- THLETE COMPOUND
- SPT / DOP / MED
- 1 Athlete Medical Station 45 sqm
- 2 Doping Control Station 80 sqm
- 3 Wax cabins 80 U
- 4 M+F Toilets
- 5 Team Captain Meeting 150 sqm
- 6 Race Office 50 sqm
- 7 Athletes gym 50 sqm
- 8 Athletes Lounge 150 sqm

- Concessions / Points of Sale (POS)
- 9 POS

- Ticketed Standing Area
- n.1200 / 1200 sqm

- Comms. Cabins
- n.45

- Cleaning & Waste Compound
- 492 sqm

- Site Management Compound
- 721 sqm

- OF / MPS / PRS / MED / CER
- LB1 VMC - FOP Medical - Ceremonies
- L00 VMC + IVH Lounge
- L01 SPP + IVH Lounge & OF Lounge.

- OF / MPS / PRS / MED / CER
- LB1 VMC - FOP Medical - Ceremonies
- L00 VMC + IVH Lounge
- L01 SPP + IVH Lounge & OF Lounge.

- OF / MPS / PRS / MED / CER
- LB1 VMC - FOP Medical - Ceremonies
- L00 VMC + IVH Lounge
- L01 SPP + IVH Lounge & OF Lounge.

- OF / MPS / PRS / MED / CER
- LB1 VMC - FOP Medical - Ceremonies
- L00 VMC + IVH Lounge
- L01 SPP + IVH Lounge & OF Lounge.

- OF / MPS / PRS / MED / CER
- LB1 VMC - FOP Medical - Ceremonies
- L00 VMC + IVH Lounge
- L01 SPP + IVH Lounge & OF Lounge.

- OF / MPS / PRS / MED / CER
- LB1 VMC - FOP Medical - Ceremonies
- L00 VMC + IVH Lounge
- L01 SPP + IVH Lounge & OF Lounge.

- OF / MPS / PRS / MED / CER
- LB1 VMC - FOP Medical - Ceremonies
- L00 VMC + IVH Lounge
- L01 SPP + IVH Lounge & OF Lounge.

- OF / MPS / PRS / MED / CER
- LB1 VMC - FOP Medical - Ceremonies
- L00 VMC + IVH Lounge
- L01 SPP + IVH Lounge & OF Lounge.

- OF / MPS / PRS / MED / CER
- LB1 VMC - FOP Medical - Ceremonies
- L00 VMC + IVH Lounge
- L01 SPP + IVH Lounge & OF Lounge.

- OF / MPS / PRS / MED / CER
- LB1 VMC - FOP Medical - Ceremonies
- L00 VMC + IVH Lounge
- L01 SPP + IVH Lounge & OF Lounge.

- OF / MPS / PRS / MED / CER
- LB1 VMC - FOP Medical - Ceremonies
- L00 VMC + IVH Lounge
- L01 SPP + IVH Lounge & OF Lounge.

- OF / MPS / PRS / MED / CER
- LB1 VMC - FOP Medical - Ceremonies
- L00 VMC + IVH Lounge
- L01 SPP + IVH Lounge & OF Lounge.

- OF / MPS / PRS / MED / CER
- LB1 VMC - FOP Medical - Ceremonies
- L00 VMC + IVH Lounge
- L01 SPP + IVH Lounge & OF Lounge.



- New Judges Tower: TEC / SPT / MPS
- 1 FoP Equipment Storage 80 sqm
- 2 Meteorological Office 20 sqm
- 3 ITO's break area 20 sqm
- 4 Jury Room 24 sqm
- 5 Competition management 45 sqm
- 6 M+F+A Toilets
- 7 OVR - T&S 60 sqm
- 8 IVH Experience 25 sqm
- 9 Jury areas 41 sqm
- 10 BRS camera platform + 10 photo position

- New Upper Stations: SPT
- 1 Athletes Services
- 2 Unisex Toilets

- New Ski Jump Towers (HS143)
- SPT / MPS / BRS
- 1 Male & Female Toilets 6sqm
- 2 Equipment Control 10 sqm
- 3 Athletes Staging Area 10 sqm
- 4 Warm Up Area 35 sqm
- 5 IVH Experience Lounge 35 sqm
- 6 BRS camera platform 8 sqm

- New Ski Jump Towers (HS109)
- SPT / BRS
- 1 Male & Female Toilets 6sqm
- 2 Equipment Control 7sqm
- 3 Staging Area 7sqm
- 4 Warm Up Area 35sqm
- 5 BRS camera platform 8sqm

- Presentation Area (FOP)
- 100 sqm

- Equipment Control
- 100 sqm

- Olympic Family Stand
- n. 145 + 4 + 4
- OF / MiCo / Spect. Ticketed Seating
- n. 330
- Spectators Ticketed Seating
- n. 515

- BIO
- 15 sqm

- Commentary Control Room (CCR)
- 60 sqm

- Ticketed Standing Area (HS143 sess.)
- n. 1400 / 1400 sqm

- Ticketed Standing Area (HS109 Sess.)
- n. 1400 / 1400 sqm

- Spectators Ticketed Seating
- n. 1210

- Workforce Check-in
- 75 sqm

- Broadcast Compound
- 4065 sqm

- Venue TEC Operations (VTO)
- 90 sqm
- Tech. Storage 150 sqm
- AV Bulk Storage 50 sqm

- Pedestrian Screening (PSA2)
- 4 lanes / 50 sqm

- Pedestrian Screening (PSA1)
- 6 lanes / 75 sqm

- Vehicle Screening Area (VSA 1)
- 2 lanes + 1PSA / 150 sqm

- Driver's Waiting
- 15 sqm

- Box Office (TBO)
- 25 sqm

- DDS / ENG / PHP / TW / TS
- PHP Load Zone 2800 sqm

- DDS Load Zone
- OBSTW Load Zone
- Workforce
- ENG Load Zone
- TS Staging Area

## PREDAZZO SKI JUMPING STADIUM Ski Jumping, Nordic Combined

### LEGEND

AREA / FUNCTION	ROUTE / FLOW		
	Pedestrian	Vehicular	Entry Point
Field Of Play			
Athletes			
Olympic / Paralympic Family			
In Venue Hospitality   *Experience			
Spectators			
Broadcast			
Press			
Security			
Venue Operations			
Ceremonies			
Unavailable / Not to be used			
Multiple Client Groups			

	Parking Area		Venue Secure Perimeter
	Load Zone		Internal Division / Fence
	PSA Pedestrian Screening Area		Inner Perimeter
	VSA Vehicles Screening Area		Existing Division / Fence
	Metro Station		

### REVISIONS

No.	STATUS	DATE
1	Venue Design Book 1	15/11/2021
2	Venue Design Book 2	28/10/2022
3	Venue Design Book 3	15/12/2023

### NOTES

### KEY PLAN

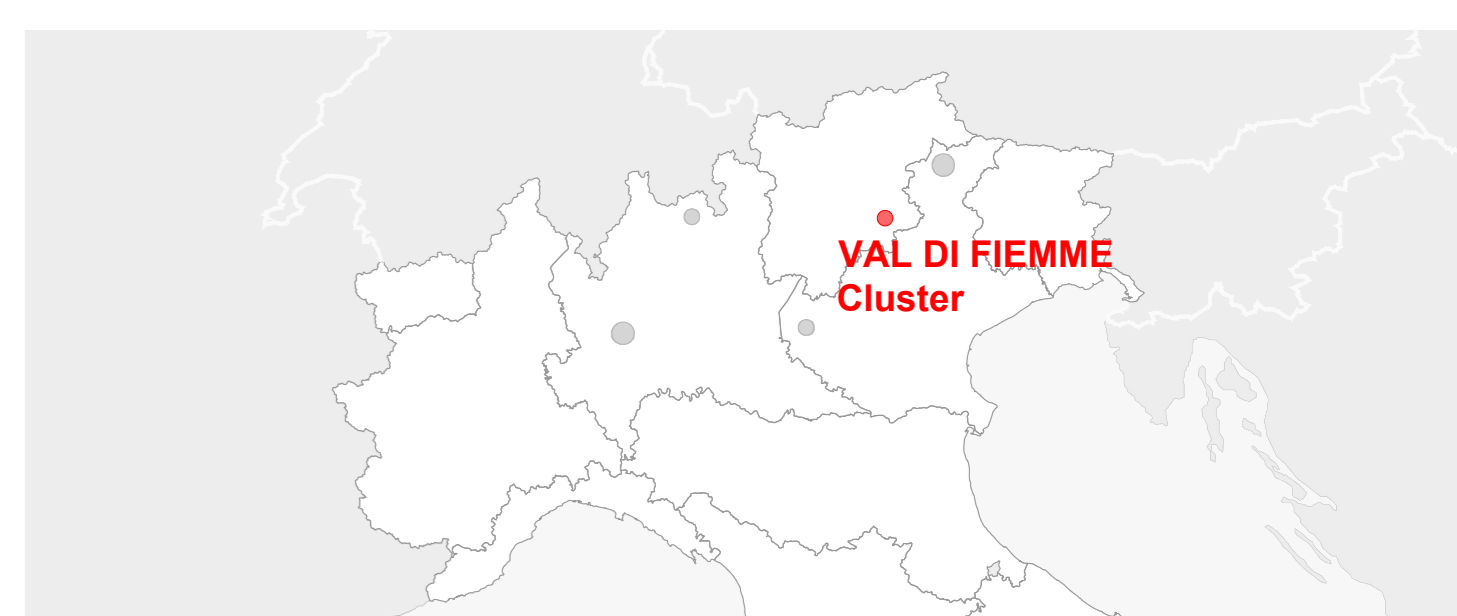

### DRAWING CODE

**42\_PSJ\_OLY\_00\_AL1**

DRAWING TITLE	DATE
Olympic Mode MASTERPLAN	15/12/2023

STATUS	REVISION No.
VENUE DESIGN BOOK 3	3

SCALE @A0	
1:1000	

BAITA ATLETI  
IF OFFICES

1 M+F+A Toilets	36 sqm
2 IF Offices	40 sqm
3 IF Work Area	45 sqm
4 IF Break Area	25 sqm
5 IF Storage	15 sqm
6 IF meeting room	

Vehicle Screening Area (VSA2)

2 lanes + 1PSA / 150 sqm

TA Load Zone - Athletes and NOCF  
TF Load Zone-International Federations

250 sqm

THLETE COMPOUND  
SPT / DOP / MED

1 Athlete Medical Station	45 sqm
2 Doping Control Station	80 sqm
3 Wax cabins	80 U
4 M+F Toilets	
5 Team Captain Meeting	150 sqm
6 Race Office	50 sqm
7 Athletes gym	50 sqm
8 Athletes Lounge	150 sqm

Concessions / Points of Sale (POS)

9 POS

Ticketed Standing Area

n.1200 / 1200 sqm

Comms. Cabins

n.45

Cleaning & Waste Compound

492 sqm

Site Management Compound

721 sqm

OF / MPS / PRS / MED / CER  
LB1 VMC - FOP Medical - Ceremonies  
L00 VMC + IVH Lounge  
L01 SPP + IVH Lounge & OF Lounge.

Ticket Resolution

16 sqm

Spectator Medical Station

39 sqm

Food & Beverage Compound

1897 sqm

WKF Lounge & Break

600 sqm

Logistic Compound

1000 sqm

VAO

45 sqm

Spectrum T&T

15 sqm

P3 / P5 / P6

1800 sqm

P3 Parking - NOC

P5 Parking - Broadcasters (OBS, MRH, ENG, PHP)

P6 Parking - Rate Card and OCOG Dedicated Vehicles

42\_PSJ\_OLY\_00\_AL3

Presentation Area (FOP)

100 sqm

Equipment Control

100 sqm

Olympic Family Stand

n. 145 + 4 + 4

OF / MiCo / Spect. Ticketed Seating

n. 330

BIO

15 sqm

Commentary Control Room (CCR)

60 sqm

Spectators Ticketed Seating

n. 515

Ticketed Standing Area (HS143 sess.)

n. 1400 / 1400 sqm

Ticketed Standing Area (HS109 Sess.)

n. 1400 / 1400 sqm

Spectators Ticketed Seating

n. 1210

Workforce Check-in

75 sqm

Broadcast Compound

4065 sqm

Venue TEC Operations (VTO)

90 sqm

Tech. Storage

150 sqm

AV Bulk Storage

50 sqm

Pedestrian Screening (PSA2)

4 lanes / 50 sqm

Pedestrian Screening (PSA1)

6 lanes / 75 sqm

Vehicle Screening Area (VSA 1)

2 lanes + 1PSA / 150 sqm

Driver's Waiting

15 sqm

Box Office (TBO)

25 sqm

DDS / ENG / PHP / TW / TS

PHP Load Zone

2800 sqm

DDS Load Zone

OBSTW Load Zone - Workforce

ENG Load Zone

TS Staging Area

New Judges Tower: TEC / SPT / MPS

1 FoP Equipment Storage	80 sqm
2 Meteorological Office	20 sqm
3 ITO's break area	20 sqm
4 Jury Room	24 sqm
5 Competition management	45 sqm
6 M+F+A Toilets	
7 OVR - T&S	60 sqm
8 IVH Experience	25 sqm
9 Jury areas	41 sqm
10 BRS camera platform + 10 photo position	

New Upper Stations: SPT

1 Athletes Services	
2 Unisex Toilets	

New Ski Jump Towers (HS143)  
SPT / MPS / BRS

1 Male & Female Toilets	6sqm
2 Equipment Control	10 sqm
3 Athletes Staging Area	10 sqm
4 Warm Up Area	35 sqm
5 IVH Experience Lounge	35 sqm
5 BRS camera platform	8 sqm

New Ski Jump Towers (HS109)  
SPT / BRS

1 Male & Female Toilets	6sqm
2 Equipment Control	7sqm
3 Staging Area	7sqm
4 Warm Up Area	35sqm
5 BRS camera platform	8sqm

42\_PSJ\_OLY\_00\_AL3

42\_PSJ\_OLY\_00\_AL2

## PREDAZZO OLYMPIC VILLAGE

### LEGEND

AREA / FUNCTION	ROUTE / FLOW		
	Pedestrian	Vehicular	Entry Point
Field Of Play			
Athletes	→	→	→
Olympic / Paralympic Family	→	→	→
In Venue Hospitality   *Experience	→	→	→
Spectators	→	→	→
Broadcast	→	→	→
Press	→	→	→
Security	→	→	→
Venue Operations	→	→	→
Ceremonies	→	→	→
Unavailable / Not to be used	→	→	→
Multiple Client Groups	→	→	→
Parking Area			
Load Zone			
PSA Pedestrian Screening Area	→	→	→
VSA Vehicles Screening Area	→	→	→
M Metro Station			
Venue Secure Perimeter	→	→	→
Internal Division / Fence	→	→	→
Inner Perimeter	→	→	→
Existing Division / Fence	→	→	→

### REVISIONS

No.	STATUS	DATE
1	Venue Design Book 1	15/11/2021
2	Venue Design Book 2	28/10/2022
3	Venue Design Book 3	15/12/2023

### NOTES

### KEY PLAN

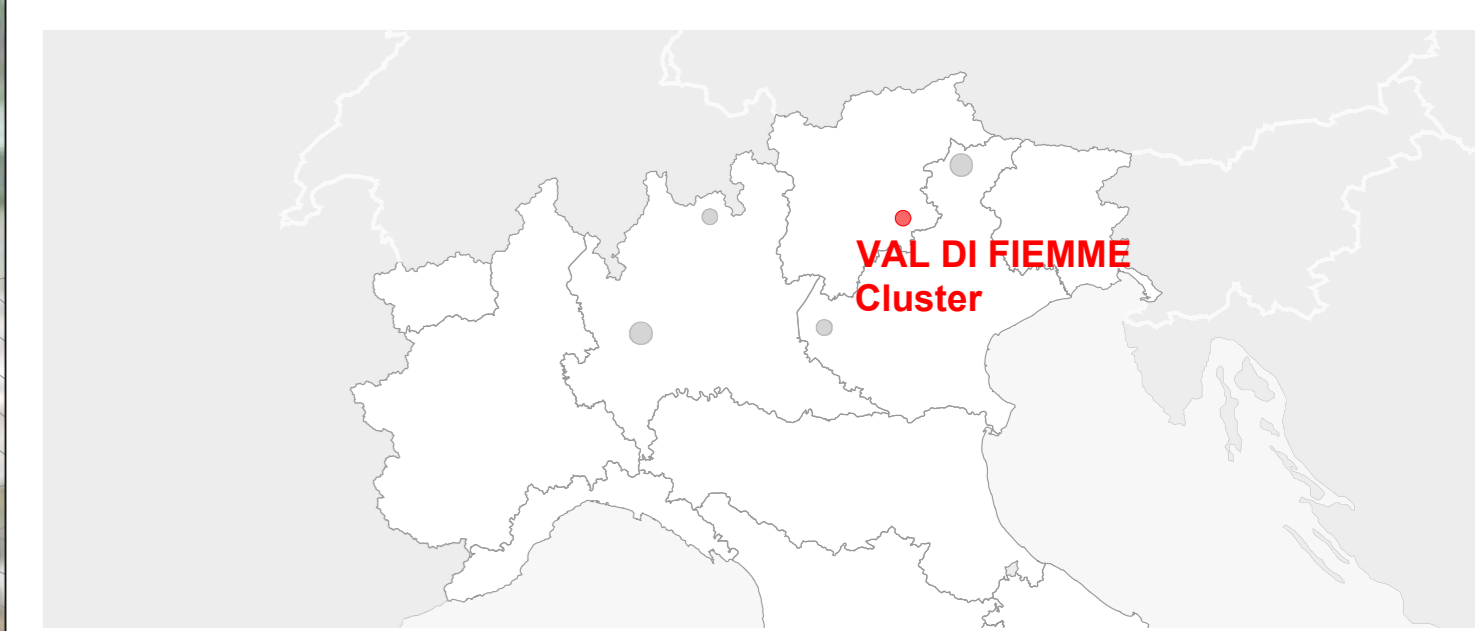

### DRAWING CODE

43\_PRV\_NCO\_00\_AL0

### DRAWING TITLE

Olympic Mode  
AERIAL VIEW

### DATE

15/12/2023

### STATUS

VENUE DESIGN BOOK 3

### REVISION No.

3

### SCALE @A0

1:500

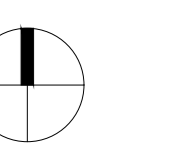
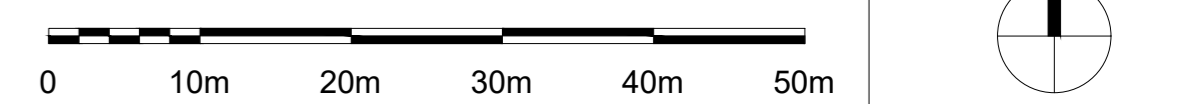



# PREDAZZO OLYMPIC VILLAGE

## LEGEND

AREA / FUNCTION	ROUTE / FLOW		
	Pedestrian	Vehicular	Entry Point
Field Of Play	Blue dashed arrow	Blue dashed arrow	Blue triangle
Athletes	Blue dashed arrow	Blue dashed arrow	Blue triangle
Olympic / Paralympic Family	Purple dashed arrow	Purple dashed arrow	Purple triangle
In Venue Hospitality   *Experience	Purple dashed arrow	Purple dashed arrow	Purple triangle
Spectators	Yellow dashed arrow	Yellow dashed arrow	Yellow triangle
Broadcast	Green dashed arrow	Green dashed arrow	Green triangle
Press	Green dashed arrow	Green dashed arrow	Green triangle
Security	Red dashed arrow	Red dashed arrow	Red triangle
Venue Operations	Orange dashed arrow	Orange dashed arrow	Orange triangle
Ceremonies	Pink dashed arrow	Pink dashed arrow	Pink triangle
Unavailable / Not to be used	Grey dashed arrow	Grey dashed arrow	Grey triangle
Multiple Client Groups	Green dashed arrow	Green dashed arrow	Green triangle

Parking Area	Diagonal hatching	
Load Zone	Orange dashed line	
PSA Pedestrian Screening Area	Red dashed line	Red circle
VSA Vehicles Screening Area	Red dashed line	Red square
M Metro Station	Red 'M' symbol	
Venue Secure Perimeter	Red dashed line	Red circle
Internal Division / Fence	Green dashed line	Green circle
Inner Perimeter	Green dashed line	Green square
Existing Division / Fence	Black dashed line	Black 'x'

## REVISIONS

No.	STATUS	DATE
1	Venue Design Book 1	15/11/2021
2	Venue Design Book 2	28/10/2022
3	Venue Design Book 3	15/12/2023

## NOTES

## KEY PLAN

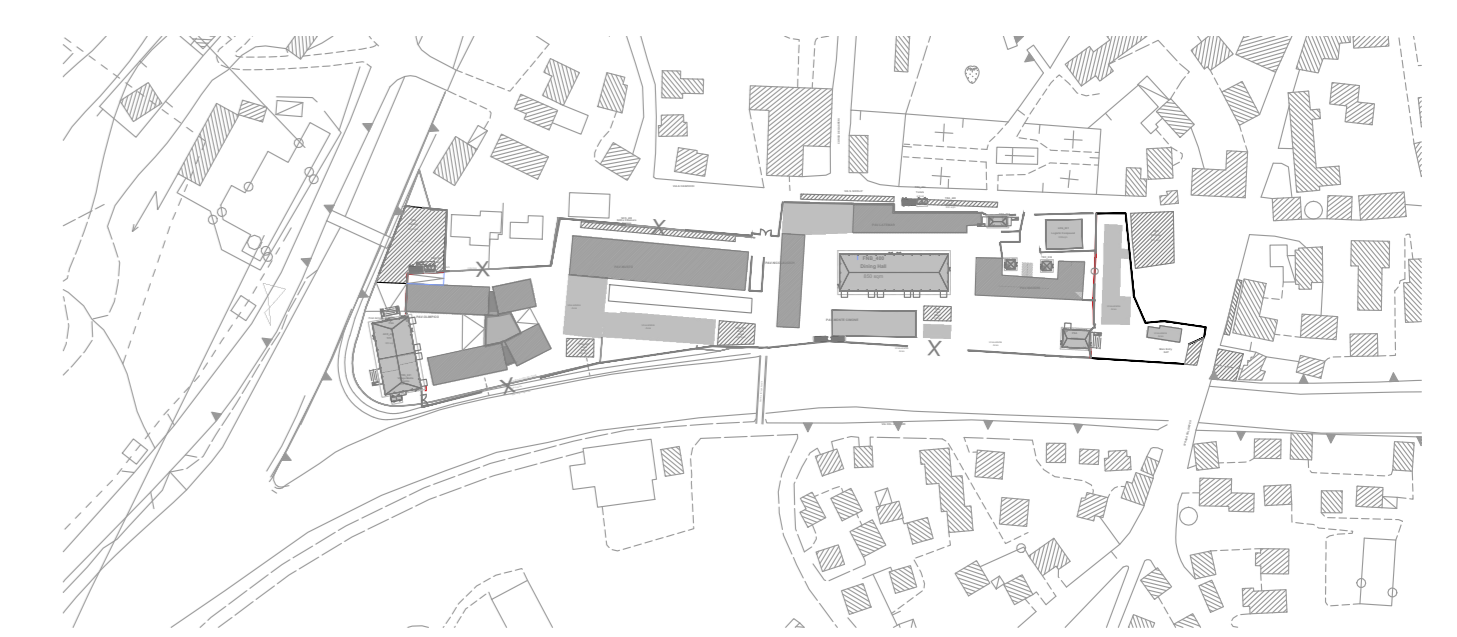

## DRAWING CODE

**43\_PRV\_NCO\_00\_AL1**

## DRAWING TITLE

**Olympic Mode  
MASTERPLAN**

## DATE

**15/12/2023**

## STATUS

**VENUE DESIGN BOOK 3**

## REVISION No.

**3**

## SCALE @A0

**1:500**

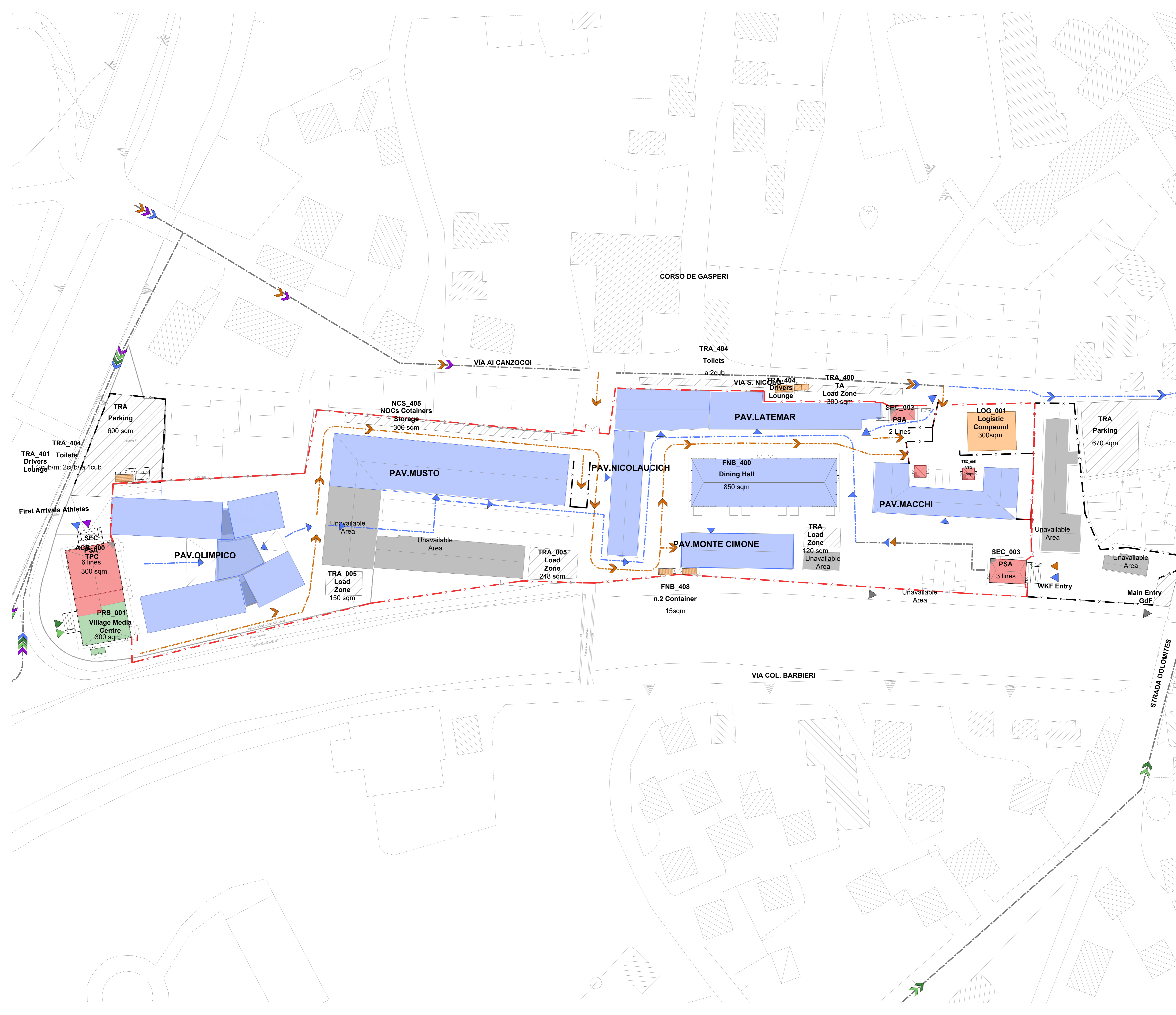
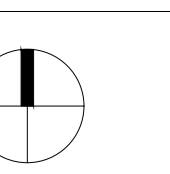
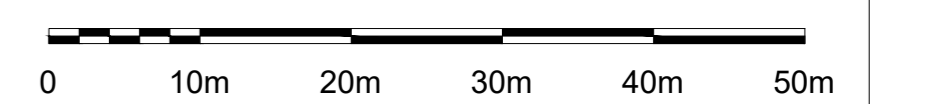

## PREDAZZO PARALYMPIC VILLAGE

### LEGEND

AREA / FUNCTION	ROUTE / FLOW		
	Pedestrian	Vehicular	Entry Point
Field Of Play	→	→	→
Athletes	→	→	→
Olympic / Paralympic Family	→	→	→
In Venue Hospitality   *Experience	→	→	→
Spectators	→	→	→
Broadcast	→	→	→
Press	→	→	→
Security	→	→	→
Venue Operations	→	→	→
Ceremonies	→	→	→
Unavailable / Not to be used	→	→	→
Multiple Client Groups	→	→	→
Parking Area	→	→	→
Load Zone	→	→	→
PSA Pedestrian Screening Area	→	→	→
VSA Vehicles Screening Area	→	→	→
M Metro Station	→	→	→
Venue Secure Perimeter	→	→	→
Internal Division / Fence	→	→	→
Inner Perimeter	→	→	→
Existing Division / Fence	→	→	→

### REVISIONS

No.	STATUS	DATE
1	Venue Design Book 1	15/11/2021
2	Venue Design Book 2	28/10/2022
3	Venue Design Book 3	15/12/2023

### NOTES

### KEY PLAN

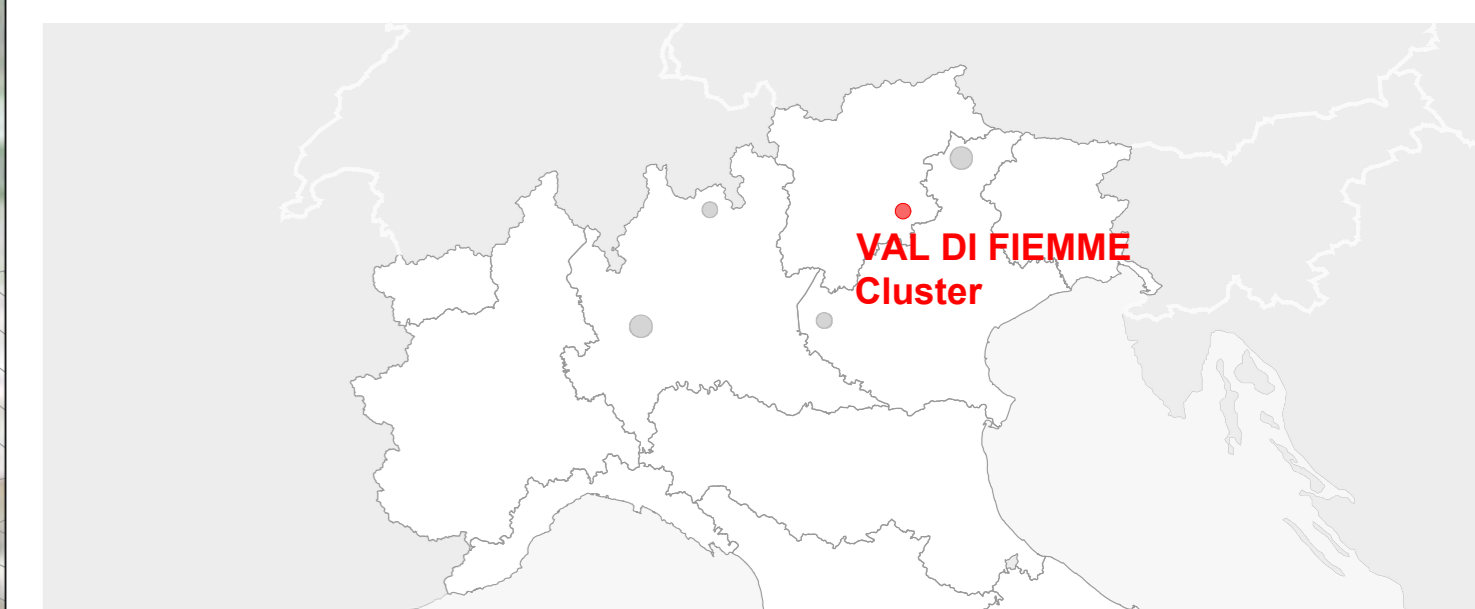

### DRAWING CODE

43\_PRV\_NPC\_00\_ALO

### DRAWING TITLE

Olympic Mode  
AERIAL VIEW

### DATE

15/12/2023

### STATUS

VENUE DESIGN BOOK 3

### REVISION No.

3

### SCALE @A0

1:500

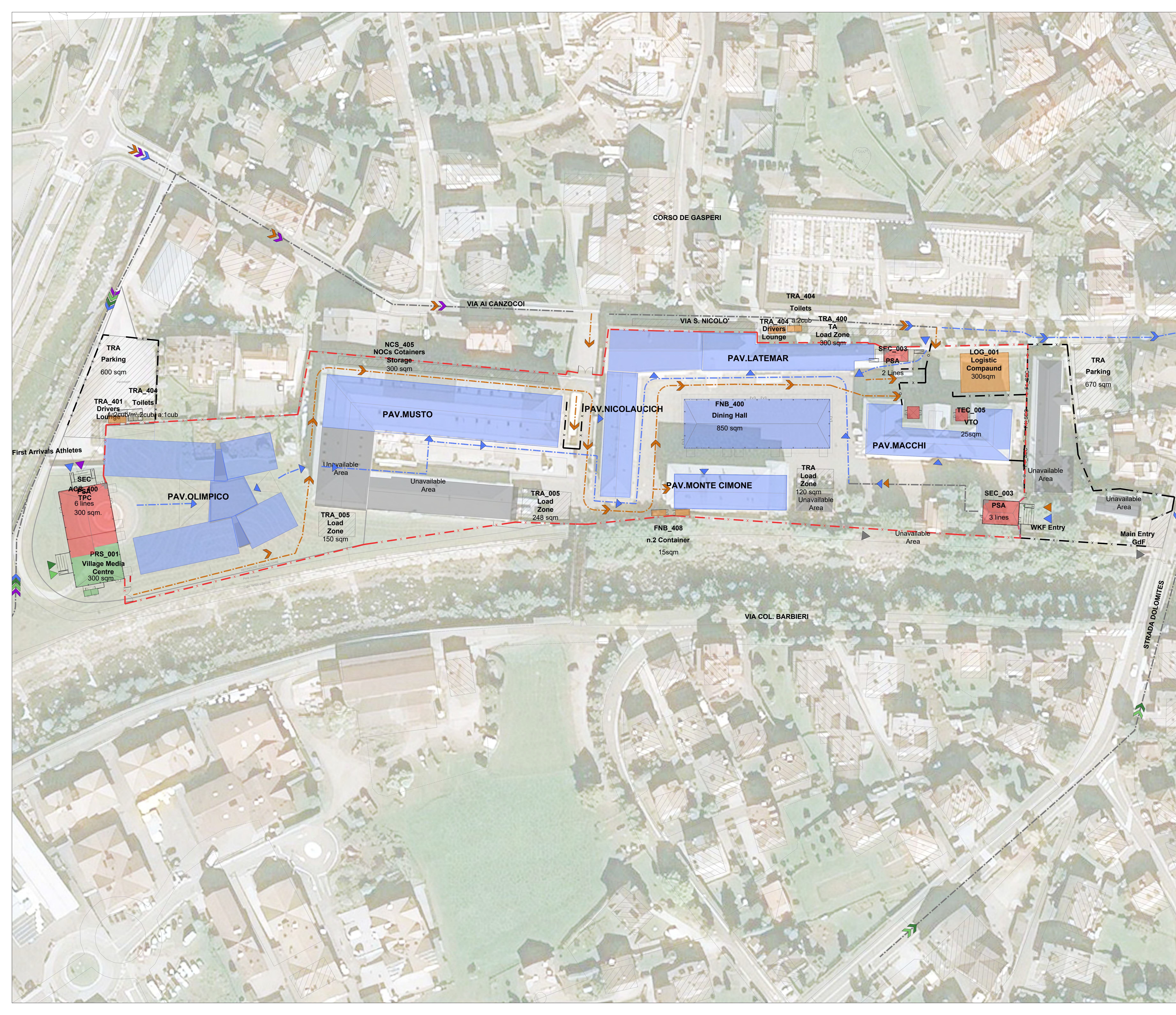
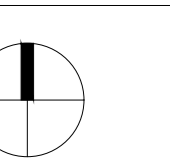
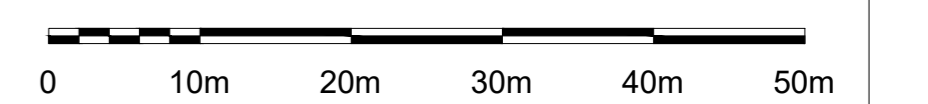

## PREDAZZO PARALYMPIC VILLAGE

### LEGEND

AREA / FUNCTION	ROUTE / FLOW		
	Pedestrian	Vehicular	Entry Point
Field Of Play			
Athletes			
Olympic / Paralympic Family			
In Venue Hospitality   "Experience"			
Spectators			
Broadcast			
Press			
Security			
Venue Operations			
Ceremonies			
Unavailable / Not to be used			
Multiple Client Groups			

	Parking Area		Venue Secure Perimeter
	Load Zone		Internal Division / Fence
	PSA Pedestrian Screening Area		Inner Perimeter
	VSA Vehicles Screening Area		Existing Division / Fence
	Metro Station		

### REVISIONS

No.	STATUS	DATE
1	Venue Design Book 1	15/11/2021
2	Venue Design Book 2	28/10/2022
3	Venue Design Book 3	15/12/2023

### NOTES

### KEY PLAN

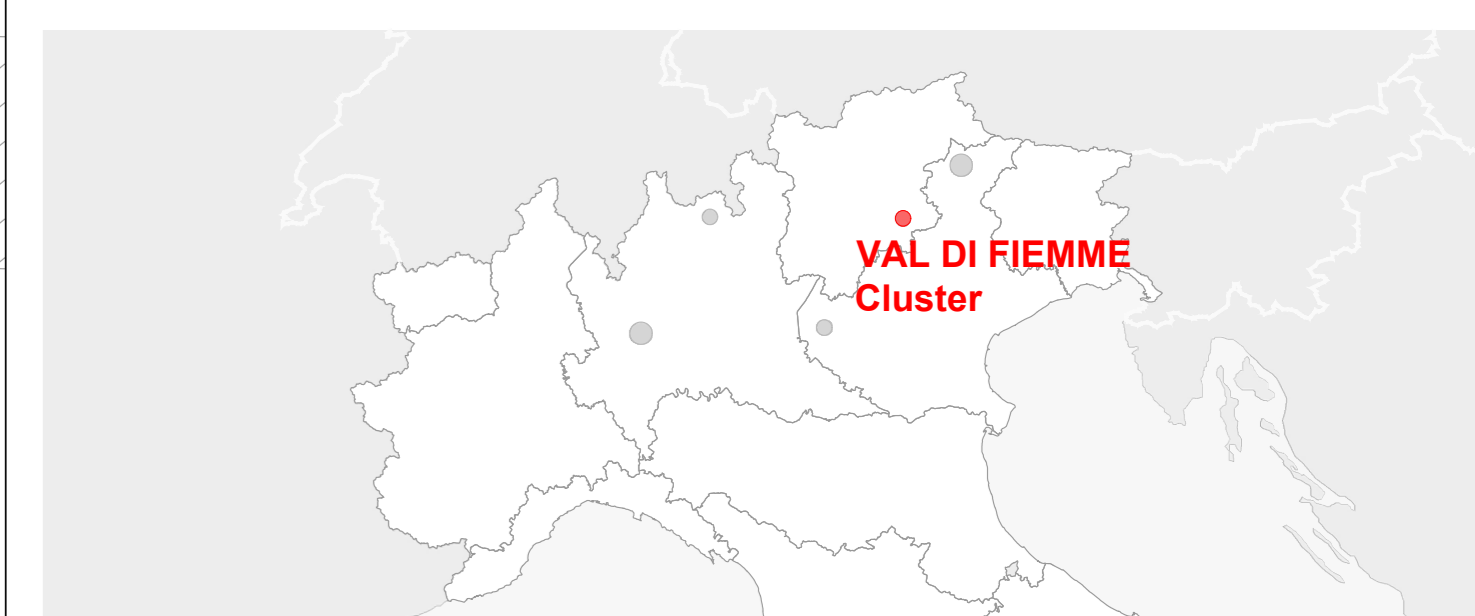

DRAWING CODE

**43\_PRV\_NPC\_00\_AL1**

DRAWING TITLE

**Olympic Mode  
MASTERPLAN**

DATE

**15/12/2023**

STATUS

**VENUE DESIGN BOOK 3**

REVISION No.

**3**

SCALE @A0

**1:500**

