

Code	Mode	Drawing Title	Scale @A0	Revision
VERONA				
ARENA DI VERONA - OLY Closing Ceremony / PAR Opening Ceremony				
51_AVR_NCO_00_AL0	OLY	Aerial View	1:1000	3
51_AVR_NCO_00_AL1	OLY	Masterplan	1:500	3
51_AVR_NCP_00_AL0	PAR	Aerial View	1:1000	3
51_AVR_NCP_00_AL1	PAR	Masterplan	1:500	3

VERONA ARENA Olympic Closing Ceremony

LEGEND

AREA / FUNCTION	ROUTE / FLOW		
	Pedestrian	Vehicular	Entry Point
Field Of Play			
Athletes	→	→	→
Olympic / Paralympic Family	→	→	→
In Venue Hospitality *Experience	→	→	→
Spectators	→	→	→
Broadcast	→	→	→
Press	→	→	→
Security	→	→	→
Venue Operations	→	→	→
Ceremonies	→	→	→
Unavailable / Not to be used	→	→	→
Multiple Client Groups	→	→	→

	Parking Area		
	Load Zone		
	PSA Pedestrian Screening Area		Venue Secure Perimeter
	VSA Vehicles Screening Area		Internal Division / Fence
	Metro Station		Inner Perimeter
			Existing Division / Fence

REVISIONS

No.	STATUS	DATE
1	Venue Design Book 1	15/11/2021
2	Venue Design Book 2	28/10/2022
3	Venue Design Book 3	15/12/2023

NOTES

KEY PLAN



DRAWING CODE

51_AVR_NCO_00_AL1

DRAWING TITLE

Olympic Mode
MASTERPLAN

DATE

15/12/2023

STATUS

VENUE DESIGN BOOK 3

REVISION No.

3

SCALE @A0

1:500

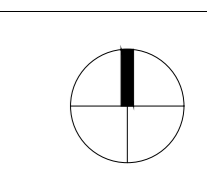
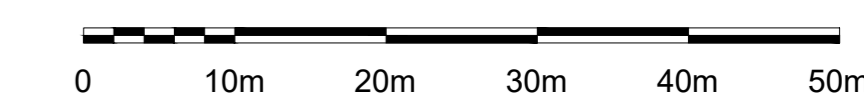

SEC_003 Pedestrian Screening Area (PSA 1) 16 lanes / 200 sqm
FNB_020 Concessions/Points of Sale (POS) 9 PoS / 75 sqm
LIC_001_01 Merchandise Kiosk 50 sqm
FNB_020 Concessions/Points of Sale (POS) 12 PoS / 100 sqm
SEC_003 Pedestrian Screening Area (PSA 3) 4 lanes / 50 sqm
ACR_001 Accreditation Area 88 sqm
SEC_003 Pedestrian Screening Area (PSA 2) 8 lanes / 100 sqm
EVS_004 Spectator Information Booth 15 sqm
TKT_001 Ticket Box Office (TBO) 15 sqm
VNI_001 Site Management Compound 971 sqm
LOG_001 Logistic Compound 571 sqm
TEC_001 TEC Compound 669 sqm

51_AVR_NCO_01_L00
51_AVR_NCO_01_L10
51_AVR_NCO_01_L20
51_AVR_NCO_01_L30
51_AVR_NCO_03_AL1

FNB_020 Concessions/Points of Sale (POS) 6 PoS / 50 sqm
FNB_020 Concessions/Points of Sale (POS) 3 PoS / 25 sqm
CNW_001 Cleaning & Waste Compound 337 sqm
FNB_001 Food & Beverage Compound 981 sqm
CER_100 Opening & Closing Ceremonies Compound 1463 sqm
MED_005 Spectator Medical Station 50 sqm
SEC_002 Vehicle Screening Area (VSA 1) 3 lanes / 225 sqm
BRS Broadcast Power Area 184 sqm
BRS_001 Broadcast Compound 1781 sqm
TRA_005 P1, P2, P3 & PX Parking 448 sqm
TRA_005_06 TX Load Zone 307 sqm

51_AVR_NCO_01_L01
51_AVR_NCO_01_L11
51_AVR_NCO_03_AL2

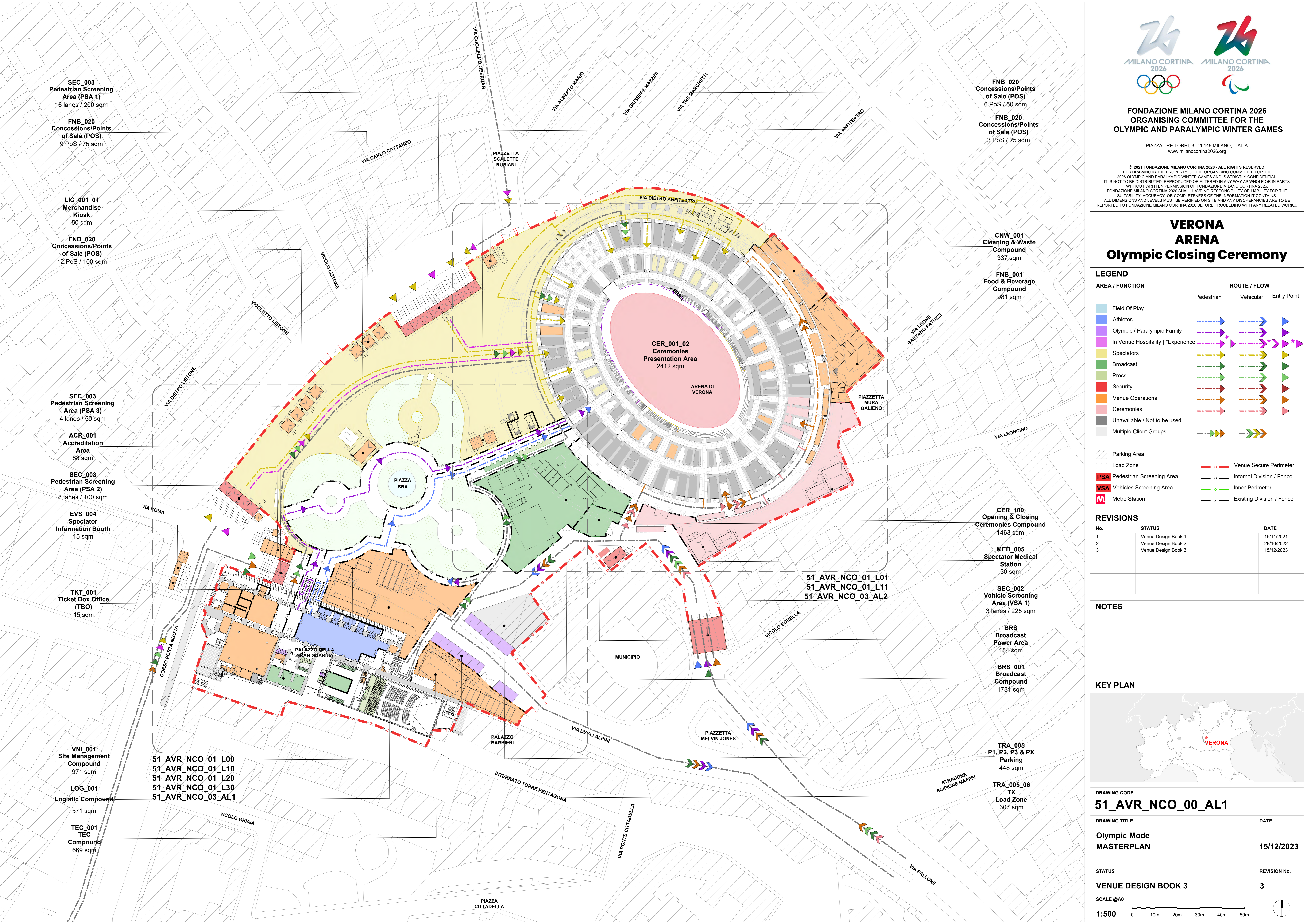

VERONA ARENA Paralympic Opening Ceremony

LEGEND

AREA / FUNCTION	ROUTE / FLOW		
	Pedestrian	Vehicular	Entry Point
Field Of Play			
Athletes			
Olympic / Paralympic Family			
In Venue Hospitality "Experience"			
Spectators			
Broadcast			
Press			
Security			
Venue Operations			
Ceremonies			
Unavailable / Not to be used			
Multiple Client Groups			

	Parking Area		Venue Secure Perimeter
	Load Zone		Internal Division / Fence
	PSA Pedestrian Screening Area		Inner Perimeter
	VSA Vehicles Screening Area		Existing Division / Fence
	Metro Station		

REVISIONS

No.	STATUS	DATE
1	Venue Design Book 1	15/11/2021
2	Venue Design Book 2	28/10/2022
3	Venue Design Book 3	15/12/2023

NOTES

KEY PLAN



DRAWING CODE
51_AVR_NCP_00_AL0

DRAWING TITLE
**Paralympic Mode
AERIAL VIEW**

DATE
15/12/2023

STATUS
VENUE DESIGN BOOK 3

REVISION No.
3

SCALE @A0
1:1000



VERONA ARENA Paralympic Opening Ceremony

LEGEND

AREA / FUNCTION	ROUTE / FLOW		
	Pedestrian	Vehicular	Entry Point
Field Of Play			
Athletes	→	→	→
Olympic / Paralympic Family	→	→	→
In Venue Hospitality *Experience	→	→	→
Spectators	→	→	→
Broadcast	→	→	→
Press	→	→	→
Security	→	→	→
Venue Operations	→	→	→
Ceremonies	→	→	→
Unavailable / Not to be used	→	→	→
Multiple Client Groups	→	→	→
Parking Area			
Load Zone			
PSA Pedestrian Screening Area			
VSA Vehicles Screening Area			
M Metro Station			
Venue Secure Perimeter	○	○	○
Internal Division / Fence	○	○	○
Inner Perimeter	○	○	○
Existing Division / Fence	x	x	x

REVISIONS

No.	STATUS	DATE
1	Venue Design Book 1	15/11/2021
2	Venue Design Book 2	28/10/2022
3	Venue Design Book 3	15/12/2023

NOTES

KEY PLAN



DRAWING CODE
51_AVR_NCP_00_AL1

DRAWING TITLE
**Paralympic Mode
MASTERPLAN**

DATE
15/12/2023

STATUS
VENUE DESIGN BOOK 3

REVISION No.
3

SCALE @A0
1:500

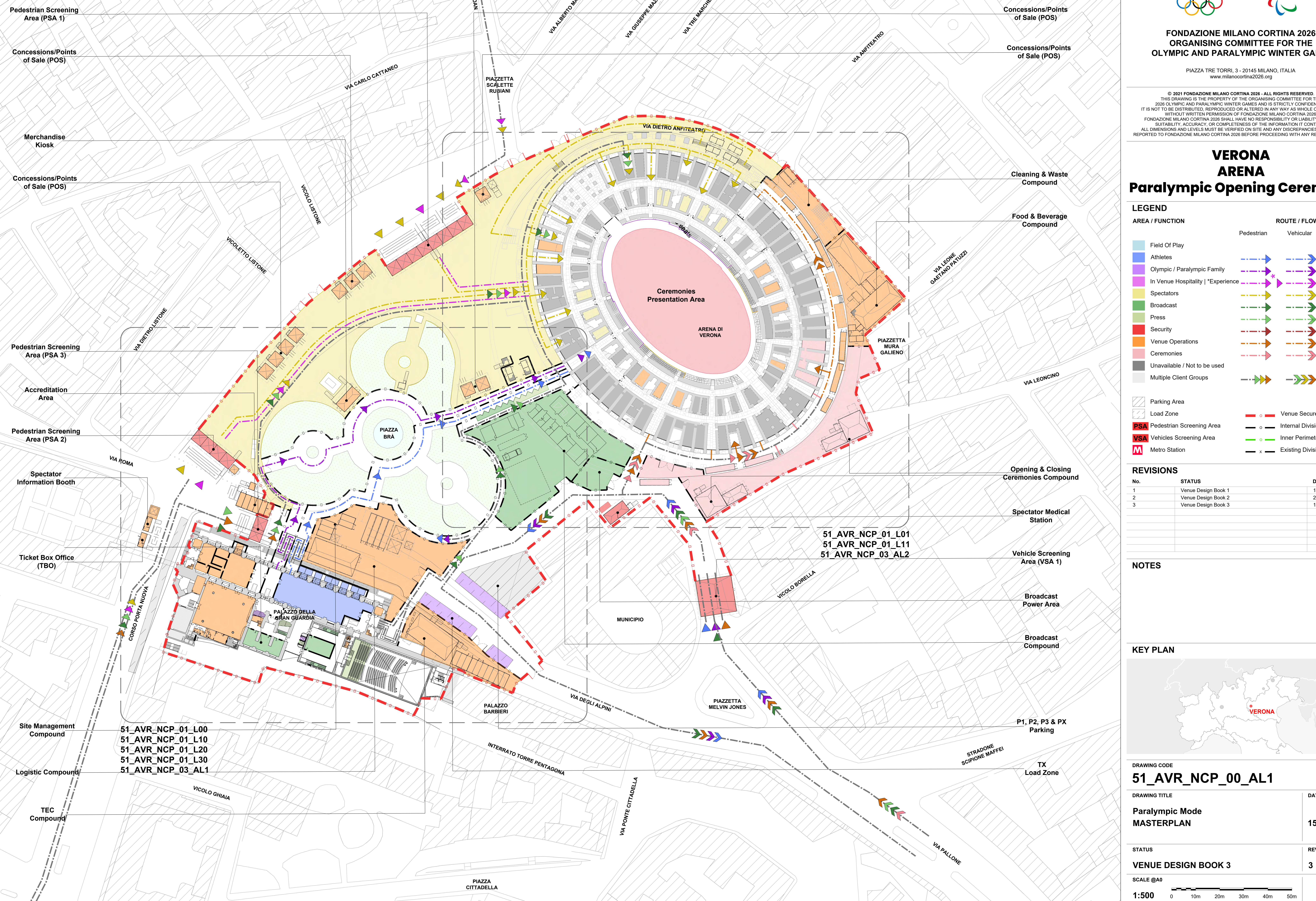

51_AVR_NCP_01_L00
51_AVR_NCP_01_L10
51_AVR_NCP_01_L20
51_AVR_NCP_01_L30
51_AVR_NCP_03_AL1

51_AVR_NCP_01_L01
51_AVR_NCP_01_L11
51_AVR_NCP_03_AL2